

608 Cabbage Tree Rd, Williamstown, NSW 2318

Sold - 6/04/2018

House 4  2  8 



## SOLD Attention Horse Lovers & Trainers - Not In The Red Zone

SOLD - Presenting "Savanah Lodge" An extremely exciting rural lifestyle opportunity. Here's your chance to live the dream on a premium 20 acre estate. You will love everything this amazing property has to offer, set for harness training and the enjoyment of the avid equine enthusiast this property is bound to get your heart racing.

**Open for Inspection**

By Appointment.

Enter this splendid estate, graced by post and rail fencing, offering dual front access to find a rendered brick homestead of substantial proportion, separate air-conditioned studio, expansive double garage with huge 7m x 8m wide carport all showcased by lush grounds, establish trees and gardens.

The immaculate family home comprises spacious light filled interiors, designed for relaxed family living and seamless flow to exceptional outdoor entertaining. Boasts generous bedrooms, central stylish bathroom with spa and glorious main bedroom with walk in robe and exquisite ensuite. The well-appointed custom-built kitchen is superb and opens to the multiple living areas where there is individual space for every member of the family. Laze or celebrate with family and friends on the rear deck while you watch the family enjoy the large grassed grounds.

The 20 acre fully fenced estate is perfect for the horse trainer or equine enthusiast as it offers fantastic horse facilities - tack room, stables, 10 fenced paddocks, 730 metre track for horse training and 130 metre dam for swimming horses.

Whether you are looking for the ideal horse/lifestyle block, to earn an income, have motorbikes or machinery, or just fancy a rural and serene 'escape to the country' then this pleasing and well set up property in an awesome location presents the perfect chance to consider the rewards of an acreage lifestyle close to the conveniences of Newcastle, Stockton Beach, Maitland, Hunter vineyards and the blue water paradise of Port Stephens.

Call today to arrange a private inspection. Trudy Zeug 0411 843 051.

"Savanah Lodge"

- Premium 20 acre fully fenced Rural Estate
- Tar sealed driveway to Exceptional four bedroom residence, large fenced yard & established gardens & trees
- Offers 2nd driveway at the front of the property
- Rendered brick construction with corrugated roof

### Listed By



Trudy Zeug  
Phone: (02) 4961 0411  
Mobile: 0411843051



**Floorplan**

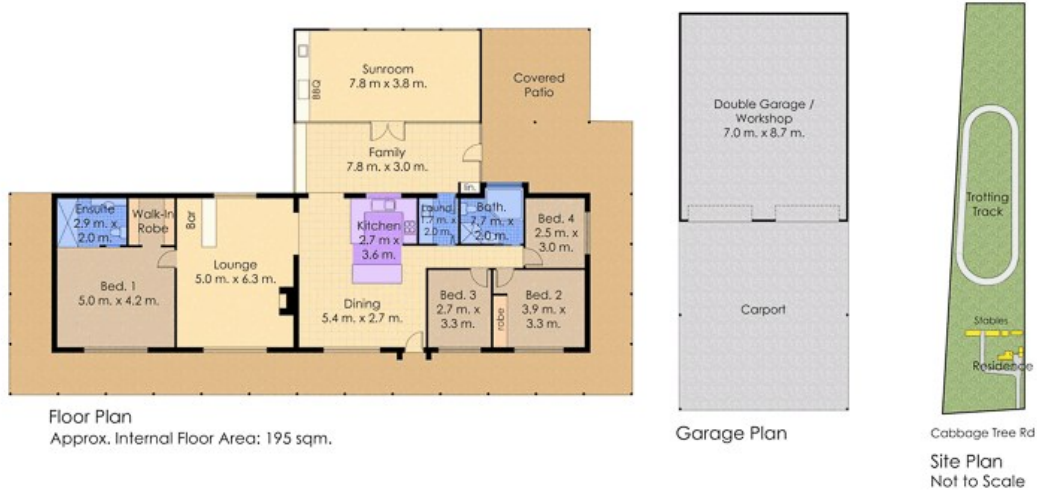

608 Cabbage Tree Rd.,  
Williamstown

0m 1 2 3 4 5   
Measurements and direction of north are approximate and are to be used as a guide only.